



FLOWFLEX

ENGLAND



Valve Specification and Technical Guide





CONTACT US

Flowflex Components Ltd.

Samuel Blaser Works, Dew Pond Lane
Tongue Lane Industrial Estate
Buxton SK17 7LR

United Kingdom

PHONE: +44 (0)1298 77211
EMAIL: hello@flowflex.com

Flowflex Components Ltd.

Warehouse #22
Dubai Investment Park 1
Dubai

UAE

PHONE: +971 4 224 2023
EMAIL: hello@flowflex.com

www.flowflex.com

About Us

For more than 60 years Flowflex has been at the forefront of designing and engineering solutions for the heating and plumbing sector, delivering innovation and technical know-how to support contractors, consultants, installers and our distribution partners.

Flowflex fittings, valves and components are now distributed around the world by our partners. We have developed a network of distributors with local expertise, promoting and supporting our products in their individual markets.

International Distribution

As our business grows we are always looking for new international opportunities and partners to work with to bring the Flowflex name to markets around the world. Our global network is expanding and we are particularly strong in the Middle East.

Our complete range of valves offers installers and specifiers a comprehensive one-stop solution for commercial and domestic applications.

Quality

To ensure quality and performance our manufacturing strictly complies with ISO 9001 quality management, the highest British and European standards and is subject to rigorous testing to ensure reliability and performance.

Therefore our confidence in these products is reflected in the guarantees that we give to you, which are at a minimum 5 years.



Female Gate Valve



Code: **L198**
Page 6

Compression Gate Valve



Code: **L197**
Page 7

Female Lockshield Gate Valve



Code: **L198LS**
Page 8

Female Lockshield Gate Valve



Code: **L198LS**
Page 9

Angle Valve 1/2" x 1/2"



Code: **AV100.1**
Page 16

Angle Valve 1/2" x 10mm



Code: **AV102.1**
Page 17

Angle Valve 1/2" x 3/8"



Code: **AV103.1**
Page 18

Angle Valve 1/2" x 3/8"



Code: **AV103.1HC**
Page 19

Pressure Reducing Valve



Code: **FTH4891NP**
Page 10

Female Lever Arm Ball Valve



Code: **811**
Page 11

Compression Lever Arm Ball Valve



Code: **711**
Page 12

Hose Union Bib Tap



Code: **L480**
Page 13

Angle Valve 1/2" x 1/2"



Code: **AV104.1**
Page 20

Angle Valve 1/2" x 10mm



Code: **AV105.1**
Page 21

Angle Valve 1/2" x 1/2"



Code: **AV106.1**
Page 22

Isolation Valve



Code: **P472CPBH**
Page 23

Brass Float Valve



Code: **BVV**
Page 14 - 15

Spring Check Valve



Code: **SPV**
Page 24

Foot Valve



Code: **SPF**
Page 25

PTFE Tape



Code: **PTFEW.01**
Page 26

L198 Female Brass Gate Valve

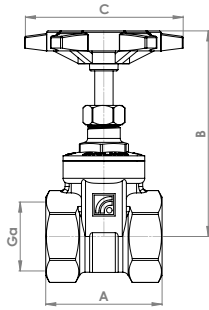
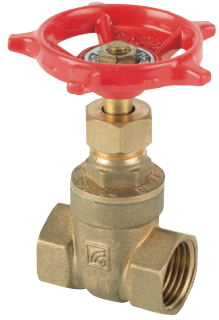

5
Year Warranty

General Specification

Manufactured to:	BS 5154	Max Working Pressure:	20 Bar
Working Medium:	Water	Max Operating Temperature:	99°C
Non Rising Stem			

Material Specification

Part	Material	Part	Material
Body	Brass CW617N	Handwheel	Aluminium
Bonnet	Brass CW617N	Handwheel Nuts	Brass CW614N
Stem	Brass CW614N	Rating Disc	Aluminium
Wedge	Brass CW617N	Seal	PTFE M139
Gland	Brass CW614N		

Product Codes & Dimensions

Code	Size (Ga)	A	B	C
L198.1	1/2"	40	72	60
L198.2	3/4"	44	79	60
L198.3	1"	55	91	65
L198.4	1 1/4"	57	106	80
L198.5	1 1/2"	59	127	95
L198.6	2"	70	144	105
L198.7	2 1/2"	84	196	115
L198.8	3"	87	213	145
L198.9	4"	112	240	145

L197 Compression Brass Gate Valve

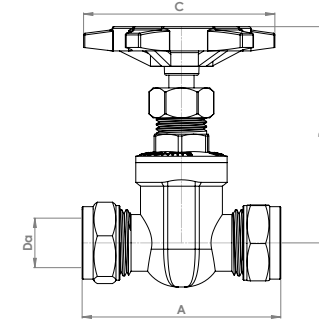

5
Year Warranty

General Specification

Manufactured to:	BS 5154	Max Working Pressure:	16 Bar
Compression Ends:	BS EN1254-2	Max Operating Temperature:	99°C
Working Medium:	Water	Non Rising Stem	

Material Specification

Part	Material	Part	Material
Body	Brass CW617N	Nuts	Brass CW617N
Bonnet	Brass CW617N	Seal	PTFE M139
Stem	Brass CW614N	Handwheel	Aluminium
Wedge	Brass CW617N	Handwheel Nut	Brass CW614N
Gland	Brass CW614N	Olive	Brass CW614N

Product Codes & Dimensions

Code	Size (Ga)	A	B	C
L197.1	15mm	63	80	60
L197.2	22mm	69	85	65
L197.3	28mm	80	93	65
L197.4	35mm	102	121	80
L197.5	42mm	106	141	100
L197.6	54mm	127	164	110

L198LS Female Lockshield Brass Gate Valve

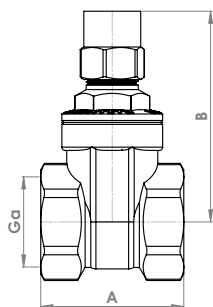
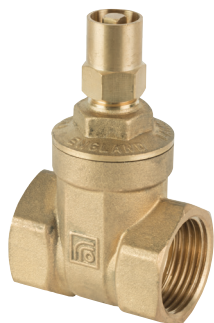

5
Year Warranty

General Specification

Manufactured to: BS 5154
 Lockshield Key for Safety
 Non Rising Stem

Max Working Pressure: 20 Bar
 Max Operating Temperature: 99°C

Material Specification

Part	Material	Part	Material
Gate Housing	Brass CW617N	Drive Column	Brass CW614N
Gate	Brass CW614N	Housing Cap	Brass CW617N
Housing Seal	PTFE M139	Washer	PTFE M139
Column Lock	Brass CW614N	Lockshield	Brass CW617N
Column Washer	Brass CW614N		

Product Codes & Dimensions

Code	Size (Ga)	A	B
L198LS.20	3/4"	44	69
L198LS.30	1"	55	78

FLSKEY.1 Lockshield Gate Valve Key



Code	Size
FLSKEY.1	One Size

L198LS Female Lockshield Brass Gate Valve

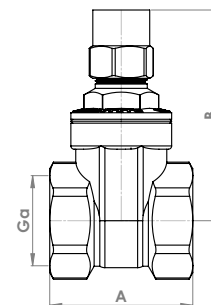

5
Year Warranty

General Specification

Manufactured to: BS 5154
 Lockshield Key for Safety
 Non Rising Stem

Max Working Pressure: 20 Bar
 Max Operating Temperature: 99°C

Material Specification

Part	Material	Part	Material
Gate Housing	Brass CW617N	Drive Column	Brass CW614N
Gate	Brass CW614N	Housing Cap	Brass CW617N
Housing Seal	PTFE M139	Lockshield	Brass CW617N
Column Lock	Brass CW614N	'O' Ring	NBR

Product Codes & Dimensions

Code	Size (Ga)	A	B
L198LS.1	1/2"	-	-
L198LS.2	3/4"	45	74
L198LS.3	1"	53	82
L198LS.4	1.1/4"	-	-
L198LS.5	1.1/2"	59	108
L198LS.6	2"	-	-

L198LS.KEY Lockshield Gate Valve Key



Code	Size
L198LS.KEY	One Size

FTH4891NP Pressure Reducing Valve

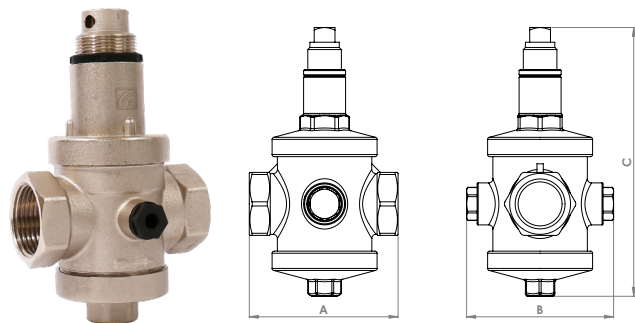

5
Year Warranty

General Specification

Maximum Inlet Pressure	16 Bar	Max Working Pressure:	25 Bar
Outlet Pressure Adjustable	0.5 to 7 Bar	Max Operating Temperature:	80°C
Factory Set Pressure	3 Bar		

Material Specification

Part	Material	Part	Material
Cover	Brass CW617N	O Ring	EPDM
Gasket	Cardboard	Spring	Stainless Steel AISI 304
Seal Holder	Brass CW617N	Cover	Brass CW617N
Gasket	EPDM	Nut	ABS Plastic
Body	Brass CW617N	Cap of Spring	Brass CW617N
Cartridge	Brass CW617N	Plug	ABS Plastic
O Ring	EPDM		

Product Codes & Dimensions

Code	Size	A	B	C
FTH4891NP.12	1/2"	70	68	123
FTH4891NP.34	3/4"	80	68	123
FTH4891NP.1	1"	85	80	138
FTH4891NP.114	1 1/4"	105	92	156
FTH4891NP.112	1 1/2"	115	92	156
FTH4891NP.2	2"	120	110	175

811 Female Lever Arm Ball Valve

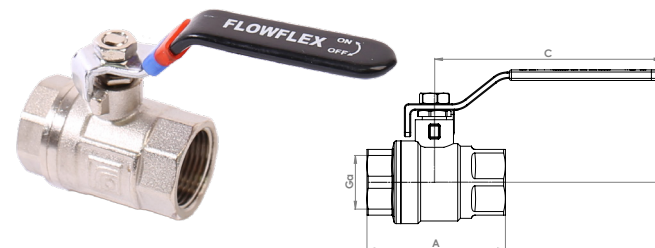

5
Year Warranty

General Specification

Max Working Pressure:	30 Bar
Max Operating Temperature:	85°C
Quarter Turn Operation	

Material Specification

Part	Material	Part	Material
8mm Nut	Brass CW617N	Sealing Bush	PTFE M139
Stem	Brass CW614N	Lever Body	Brass CW617N
Lock Nut	Brass CW617N	Ball Bushing	PTFE M139
Handle	Stainless Steel AISI 304	Ball Valve	Brass CW614N
Handle Grip	Rubber	Screw End Cap	Brass CW617N

Product Codes & Dimensions

Code	Size (Ga)	A	B	C
8111	1/2"	46	40	85
8112	3/4"	53	47	85
8113	1"	61	62	99
8114	1 1/4"	72	75	117
8115	1 1/2"	84	82	117
8116	2"	94	87	132
8117	2 1/2"	119	119	235
8118	3"	142	127	235
8119	4"	169	142	235

711 Compression Lever Arm Ball Valve

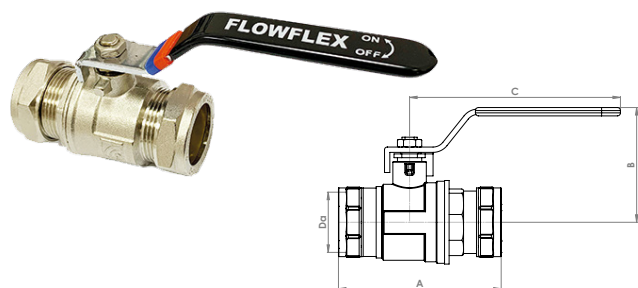

5
Year Warranty

General Specification

Compression Ends: BS EN1254-2
 Quarter Turn Operation
 Max Working Pressure: 30 Bar
 Max Operating Temperature: 85°C

Material Specification

Part	Material	Part	Material
Body	Brass CW617N	O-Ring	N7118F - NBR
Ball	Brass CW614N	Lever	Stainless Steel AISI 304
Stem	Brass CW614N	Handle Nut	Brass CW617N
Seat	PTFE M139		
Friction Washer	PTFE M139		

Product Codes & Dimensions

Code	Size (Ga)	A	B	C
7111	15mm	62	45	85
7117	18mm	74	50	83
7112	22mm	69	49	85
7113	28mm	85	63	127
7114	35mm	109	76	139
7115	42mm	125	94	139
7116	54mm	141	99	160

L480 Hose Union Bib Tap

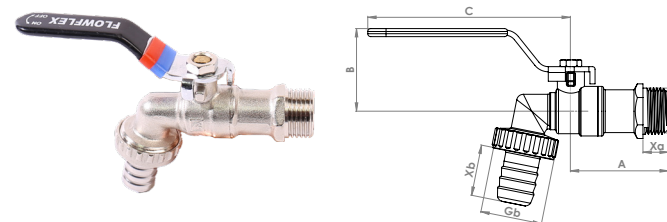

5
Year Warranty

General Specification

Quarter Turn Operation
 c/w Hose Connection
 Max Working Pressure: 10 Bar
 Max Operating Temperature: 85°C

Material Specification

Part	Material
Male Body	Brass CW617N Nickel Plated
Lever	Stainless Steel AISI 304
Lever Nut	Brass CW617N Nickel Plated
Valve Shaft	Brass CW617N
Lever Handle	ABS Plastic
Main Body	Brass CW617N Nickel Plated
Nut	Brass CW617N Nickel Plated
O Ring	N7118F - NBR
Spigot	Brass CW617N Nickel Plated
Filter	Plastic - Acetal. M90.
Valve Ball	Brass CW617N Nickel Plated

Product Codes & Dimensions

Code	Size (Ga)	A	B	C	Xa	Xb
L480.2	1/2"	85	40	79	12	21
L480.3	3/4"	104	43	79	13	24
L480.4	1"	116	52	102	14	31

BVV Brass Float Valve

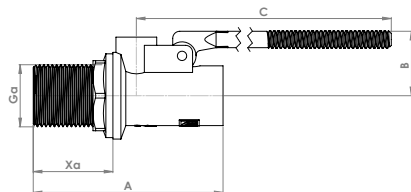
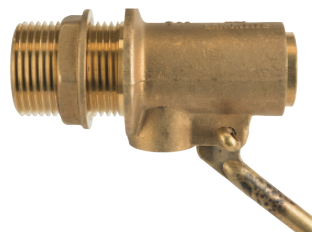

Product Codes & Dimensions

Code	Size (Ga)	A	B	C	Xa	Seat Bore	Tail Length	Lever Size	Float Size
BW.11	1/2"	76	31	268	31	1/8"	1 1/4"	10 x 5/16"	4 1/2" x 5/16" W
BW.12	3/4"	81	35	366	33	1/4"	1 1/2"	13 x 5/16"	5" x 5/16" W
BV.13	1"	92	49	42	38	3/8"	1 1/2"	14 x 3/8"	6" x 3/8" W
BW.14	1 1/4"	105	49	466	48	1/2"	2"	17 x 3/8"	8" x 3/8" W
BV.15	1 1/2"	111	58	480	49	5/8"	2"	21 x 1/2"	10" x 1/2" W
BW.16	2"	123	69	514	50	5/8"	2"	21 x 1/2"	10" x 1/2" W

BVF Plastic Float for Ball Valves



Code	Float Size
BVF.19	4 1/2" x 5/16" W
BVF.20	5" x 5/16" W
BVF.21	6" x 3/8" W
BVF.22	8" x 3/8" W
BVF.23	10" x 1/2" W

*Copper Float for Ball Valves available on request

BVV Brass Float Valve



5
Year Warranty

General Specification

Max Working Pressure: 14 Bar

Max Operating Temperature: 85°C

Material Specification

Part	Material	Part	Material
Body	Brass CW617N	Rubber Gasket Disc	EPDM EP7118F
Arm	Brass CW617N	Rubber Gasket Washer	EPDM EP7118F
Back Nut	Brass CW617N	Split Pin	Brass CW617N
Shuttle	Brass CW617N		

Flow Rate & Size Selection Chart (GPM)

Static Pressure PSI	1/2"	3/4"	1"	1 1/4"	1 1/2"	2"
0.5	0.25	0.82	1.85	2.50	5.90	11.70
1.0	0.35	1.16	2.60	3.50	8.30	16.50
2.0	0.50	1.65	3.70	4.90	11.80	23.50
4.0	0.70	2.33	5.20	6.90	16.60	33.70
7.0	0.93	3.10	6.90	9.20	21.90	43.10
10.0	1.10	3.70	8.20	11.00	26.30	52.50
15.0	1.40	4.50	10.10	13.50	32.30	64.40
20.0	1.60	5.20	11.70	15.60	37.30	74.40
25.0	1.76	5.80	13.00	17.40	41.60	83.10
30.0	1.93	6.40	14.30	19.10	45.60	91.00
35.0	2.10	6.90	15.40	20.60	49.20	98.30
40.0	2.20	7.40	16.50	22.00	52.60	105.00

AV100.1 Angle Valve

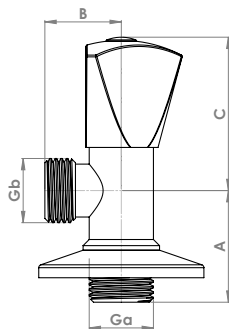

5
Year Warranty

General Specification

1/2" x 1/2" Angle Valve with Tricorn Handle and Hot / Cold Indicator

Max Working Pressure: 10 Bar

Max Operating Temperature: 100°C

Material Specification

Part	Material
Body	Brass CW617N Chrome Plated
Bushing	Brass CW614N
Press Cap	Brass CW614N
Handle	Zinc Alloy Chrome Plated
Rosette	Stainless Steel AISI 304
Spindle Screw	Brass CW614N
Hot / Cold Indicator	ABS Plastic
Clip	Stainless Steel AISI 304
O Ring	N7118F - NBR
O Ring	N8118F - NBR

Product Codes & Dimensions

Code	Size (Ga, Gb)	A	B	C
AV100.1	1/2" x 1/2"	38	25	46

AV102.1 Angle Valve

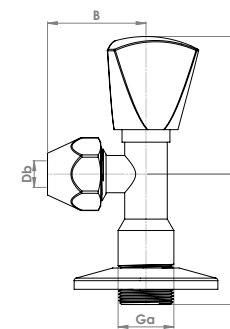

5
Year Warranty

General Specification

1/2" x 1/2" (10mm) Angle Valve with Tricorn Handle and 10mm Compression Nut

Max Working Pressure: 10 Bar

Max Operating Temperature: 100°C

Material Specification

Part	Material
Body	Brass CW617N Chrome Plated
Spindle	Brass CW614N
Handle	Zinc Alloy Chrome Plated
Compression Nut	Brass CW614N Chrome Plated
Olive	Brass CW509L
O Ring	N8118F - NBR
Rosette	Stainless Steel AISI 304
Thrust Washer	Stainless Steel AISI 304
O Ring	N7118F - NBR

Product Codes & Dimensions

Code	Size (Ga, Gb, Db)	A	B	C
AV102.1	1/2" x 1/2" 10mm	45	34	54

AV103.1 Angle Valve

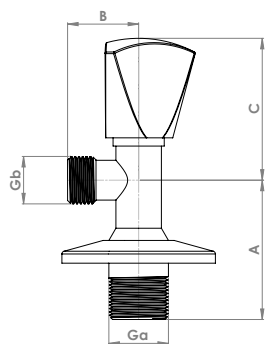

5
Year Warranty

General Specification

1/2" x 3/8" Angle Valve with Tricorn Handle and 3/8" Outlet

Max Working Pressure: 10 Bar

Max Operating Temperature: 100°C

Material Specification

Part	Material
Body	Brass CW617N Chrome Plated
Spindle	Brass CW614N
Handle	Zinc Alloy Chrome Plated
Thrust Washer	Stainless Steel AISI 304
O Ring	N7118F - NBR
O Ring	N8118F - NBR
Rosette	Stainless Steel AISI 304

Product Codes & Dimensions

Code	Size (Ga, Gb)	A	B	C
AV103.1	1/2" x 3/8"	48	25	53

AV103.1HC Angle Valve

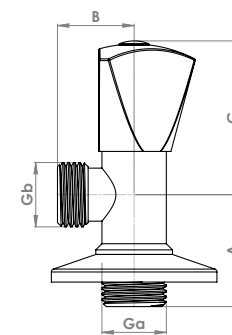

5
Year Warranty

General Specification

1/2" x 3/8" Angle Valve with Tricorn Handle and Hot / Cold Indicator

Max Working Pressure: 10 Bar

Max Operating Temperature: 100°C

Material Specification

Part	Material
Body	Brass CW617N Chrome Plated
Spindle	Brass CW614N
Handle	Zinc Alloy Chrome Plated
Thrust Washer	Stainless Steel AISI 304
O Ring	N7118F - NBR
O Ring	N8118F - NBR
Rosette	Stainless Steel AISI 304
Screw	Brass CW614N
Hot / Cold Indicator	ABS Plastic

Product Codes & Dimensions

Code	Size (Ga, Gb)	A	B	C
AV103.1HC	1/2" x 3/8"	47	25	43

AV104.1 Angle Valve

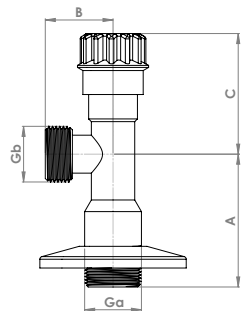

5
Year Warranty

General Specification

1/2" x 1/2" Angle Valve with Multi Rib Handle

Max Working Pressure: 10 Bar

Max Operating Temperature: 100°C

Material Specification

Part	Material
Body	Brass CW617N Chrome Plated
Spindle	Brass CW614N
Rosette	Stainless Steel AISI 304
O Ring	N7118F - NBR
O Ring	N8118F - NBR
Thrust Washer	Stainless Steel AISI 304
Handle	Plastic Chrome Plated

Product Codes & Dimensions

Code	Size (Ga, Gb)	A	B	C
AV104.1	1/2" x 1/2"	48	25	37

AV105.1 Angle Valve

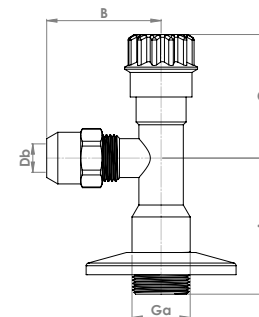

5
Year Warranty

General Specification

1/2" x 3/8" Angle Valve with Multi Rib Handle and 10mm Compression Nut

Max Working Pressure: 10 Bar

Max Operating Temperature: 100°C

Material Specification

Part	Material
Body	Brass CW617N Chrome Plated
Valve	Brass CW614N
Rosette	Zinc Alloy Chrome Plated
O Ring	N7118F - NBR
O Ring	N8118F - NBR
Thrust Washer	Stainless Steel AISI 304
Handle	Plastic Chrome Plated
Compression Nut	Brass CW614N Chrome Plated
Gasket	N8118F - NBR
Split Olive	Brass CW614N

Product Codes & Dimensions

Code	Size (Ga, Gb, Db)	A	B	C
AV105.1	1/2" x 3/8" 10mm	48	40	38

AV106.1 Angle Valve

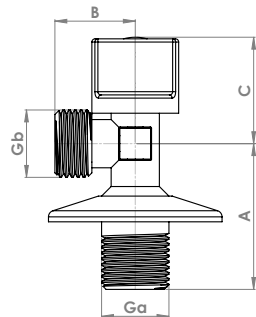

5
Year Warranty

General Specification

1/2" x 1/2" Angle Valve with Quarter Turn Handle and Hot / Cold Indicator

Max Working Pressure: 10 Bar

Max Operating Temperature: 100°C

Material Specification

Part	Material
Body	Brass CW617N Chrome Plated
Valve	Brass CW614N
O Ring	N8118F - NBR
Set Screw	Brass CW614N
Handle	Plastic Chrome Plated
Screw	Brass CW614N
Hot / Cold Indicator	ABS Plastic
Rosette	Stainless Steel AISI 304
O Ring	N7118F - NBR

Product Codes & Dimensions

Code	Size (Ga, Gb)	A	B	C
AV106.1	1/2" x 1/2"	45	24	34

P472CPBH Chrome Plate Isolation Valve with Black Handle

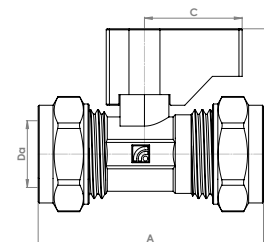

5
Year Warranty

General Specification

Compression Ends: BS EN1254-2

Quarter Turn Handle

Max Working Pressure: 10 Bar

Max Operating Temperature: 85°C

Material Specification

Part	Material
Body	Brass CW617N Chrome Plated
Ball	Stainless Steel AISI 304
Ball Sealing Ring	PTFE M139
Drive Column	Brass CW617N
Drive Column Sealing Ring	PTFE M139
Ball Retainer	Stainless Steel AISI 304
Nut	Brass CW617N Chrome Plated
Olive	Brass CW509L
Valve Handle	ABS Plastic
Handle Screw	Stainless Steel AISI 304

Product Codes & Dimensions

Code	Size (Da)	A	B	C
P472CPBH.1	15mm	60	30	22
P472CPBH.2	22mm	70	32	22

SPF Foot Valve

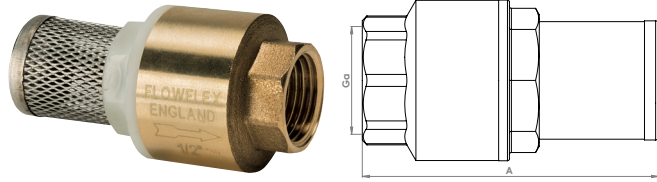

5
Year Warranty

General Specification

Max Working Pressure:	1/2" to 1"	10 Bar	Max Operating Temperature:	90°C
	1 1/4" to 2"	8 Bar		
	2 1/2" to 4"	6 Bar		

Material Specification

Part	Material
Body	Brass CW617N
Spring	Stainless Steel AISI 304
Plunger	Nylon
Nut	Nylon
Mesh	Stainless Steel AISI 304
Washer	NBR

Product Codes & Dimensions

Code	Size (Ga)	Max Pressure	A
SPF.1	1/2"	10	69
SPF.2	3/4"	10	78
SPF.3	1"	10	88
SPF.4	1 1/4"	8	106
SPF.5	1 1/2"	8	116
SPF.6	2"	8	140
SPF.7	2 1/2"	6	148
SPF.8	3"	6	177
SPF.9	4"	6	195

SPV Spring Check Valve

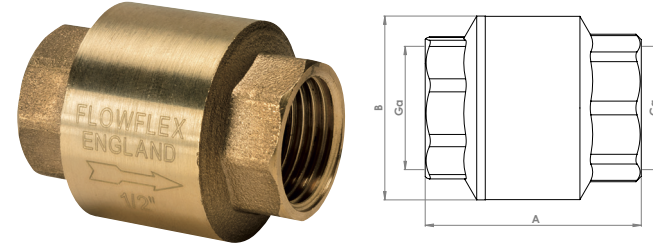

5
Year Warranty

General Specification

Max Working Pressure:	1/2" to 1"	10 Bar	Max Operating Temperature:	90°C
	1 1/4" to 2"	8 Bar		
	2 1/2" to 4"	6 Bar		

Material Specification

Part	Material
Body	Brass CW617N
Spring	Stainless Steel AISI 304
Plunger	Brass
Washer	NBR

Product Codes & Dimensions

Code	Size (Ga)	Max Pressure	A	B
SPV.1	1/2"	10	45	35
SPV.2	3/4"	10	48	41
SPV.3	1"	10	53	45
SPV.4	1 1/4"	8	67	56
SPV.5	1 1/2"	8	75	65
SPV.6	2"	8	80	80
SPV.7	2 1/2"	6	92	95
SPV.8	3"	6	101	109
SPV.9	4"	6	121	110

PTFEW.01 PTFE Tape



5
Year Warranty

General Specification

12mm PTFE Tape for Water



Flowflex Components Ltd.
Samuel Blaser Works, Dew Pond Lane,
Tongue Lane Industrial Estate,
Buxton SK17 7LR, United Kingdom

Tel: +44 (0)1298 77211
www.flowflex.com
hello@flowflex.com



Flowflex Components Ltd.
Warehouse #22
Dubai Investment Park 1
Dubai, UAE

Tel: +971 4 224 2023
www.flowflex.com
hello@flowflex.com

Flowflex reserves the right to alter the product range and specifications contained in this guide without prior notice.